

2

3

4

5

6

7

REVISION DATA		
REV	DESCRIPTION	DATE
A0	NEW DRAWING	16-6-3

Technical Data

Material:

Pin(outer sleeve): Brass, machined CuZn38Pb2

Plating(outer sleeve):

Tin Plated: 2μm/80μm"Ni, 5μm/200μ"Sn

Gold Plated: 2μm"/80μm"Ni, 0.8μ" gold

Insulator: PPS UL94V-0

Electrical:

Current rating: 3Amps/contact max.

Contact resistance: ≤4mΩ/contact

Insulation resistance: ≥1000MΩ at V=100V

Dielectric Withstanding Voltage: 1000V AV Min

Operating voltage: 60VAC/DC

Mechanical:

Operating temperature: -40 °C to +105 °C

Soldering temperature: +255 °C

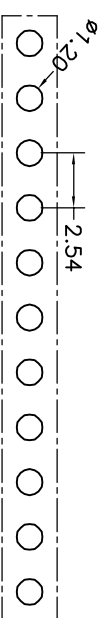
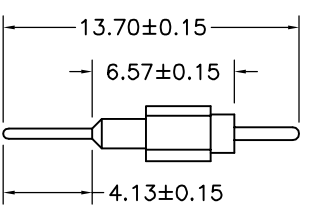
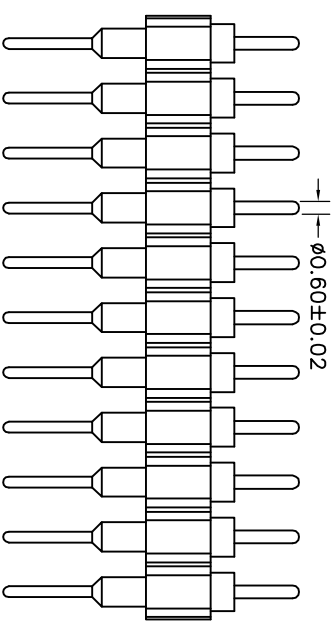
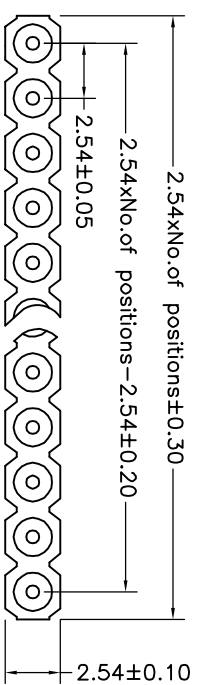

P. C. B LAYOUT

QZT	X	X	-	X	XX	XX	XXXX	X
Pitch (mm) A=1.27 B=1.778 C=2.00 D=2.54	Insulator Type code 1=Single row 2=Double row 3=Three row	Angel Options D=180° R=90° S=SMT I=IC	No. of Positions XX positions	Pin plated T1=Tin 150μ" T2=Tin 200μ" G1=G/P G2=Gold 3μ" G3=Gold 10μ" G4=Gold 15μ" G5=Gold 30μ"	Pin Length Options 1370=13.70mm	Specifications A=Public seat B=Female seat		

dzttconn 启之泰 东莞市启之泰电子科技有限公司

TOLERANCE	PROJECTION	TITLE:
X, XXX ±0.05	2016-6-3	Single socket connector 2.54mm
X, XX ±0.15	DATE:	L=13.70mm H=3.0mm
X, X ±0.20	DRAWN: TANG-S-G	PART NO: QZTD1-DXXXX1370A
ANGLE ±0.30	CHECKED:	DRAWING NO: 2016060307
±5.0°	APPROVED:	REV: A0 UNIT: mm SCALE: 1:1 SIZE: A4