

REVISION DATA		
REV	DESCRIPTION	DATE
A0	NEW DRAWING	16-5-5

1.778xNo. of positions+0.60±0.30

1.778±0.05

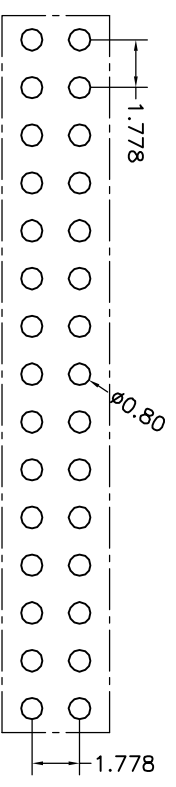
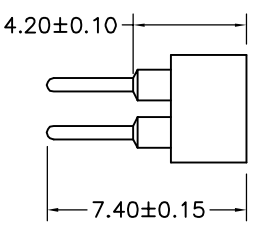
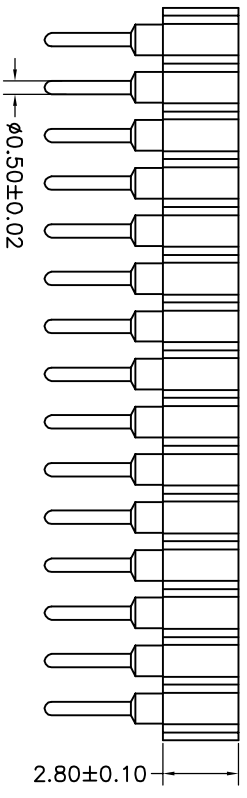
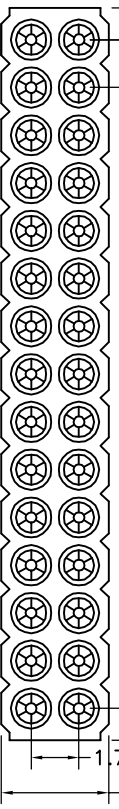

P. C. B LAYOUT

QZT	X	X	-	X	XX	XX	XX	XXX	X
Pitch(mm)	Insulator Type code								
A=1.27	1-Single row								
B=1.778	2-Double row								
C=2.00	3-Three row								
D=2.54									
Angel Options	D=180°								
R=90°	S=SMT								
T=IC									
No. of Positions	XX positions								
Pin plated	T1=Tin 150μ"								
T2=Tin 200μ"	G1=6/F								
G2=gold 3μ"	G3=gold 10μ"								
G4=gold 15μ"	G5=gold 30μ"								
ClIP plated	T1=Tin 150μ"								
T2=Tin 200μ"	G1=6/F								
G2=gold 3μ"	G3=gold 10μ"								
G4=gold 15μ"	G5=gold 30μ"								
Pin Length Options	07=10-F, 40mm								
Specifications	A=Public seat								
B=Female seat									

Technical Data  
 Material: Pin(outer sleeve): Brass, machined CuZn38Pb2  
 Plating(outer sleeve):  
 Tin Plated: 2μm/80μm"Ni, 5μm/200μ"Sn  
 Gold Plated: 2μm"/80μm"Ni, 0.8μ" gold  
 Plating(Contact): 2μm/80μ"Ni, gold or Tin plated  
 Insulator: PPS UL94V-0  
 ClIP(Contact 6 Flinger): Beryllium copper, heat teated

Electrical:  
 Current rating: Amps/contact max.  
 Contact resistance: ≤4m Ω/contact  
 Insulation resistance: ≥1000M Ω at V=100V  
 Operating voltage: 60VAC/DC

Mechanical:  
 Average Insertion force with steel pin of ø0.432: <90g  
 Average withdrawal force with steel pin of ø0.432: >25g  
 Mechanical life cycle: min 200  
 Operating temperature: -40 °C to +105 °C  
 Soldering temperature: +255 °C

**Qzconn** 东莞市启之泰电子科技有限公司  
 启之泰

TOLERAVCE	PROJECTION	TITLE:
X. XXX ±0.05		Double row socket connector
X. XX ±0.15	DATE: 2016-5-5	1.778mm L=7.40mm
X. X ±0.20	DRAWN: TANG-S-G	PART NO: QZTB2-DXXXXXX0740B
X. ±0.30	CHECKED:	DRAWING NO: 2016050501
ANGLE ±5.0°	APPROVED:	REV: A0 UNIT: mm SCALE: FULL SIZE: A4