

2

3

4

5

6

7

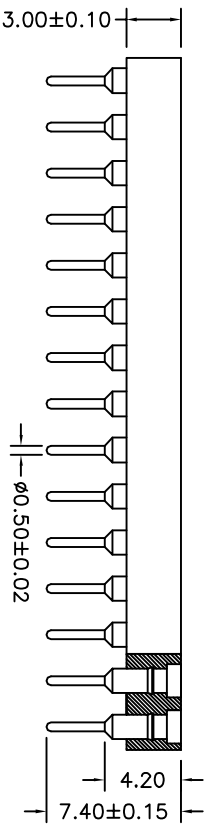
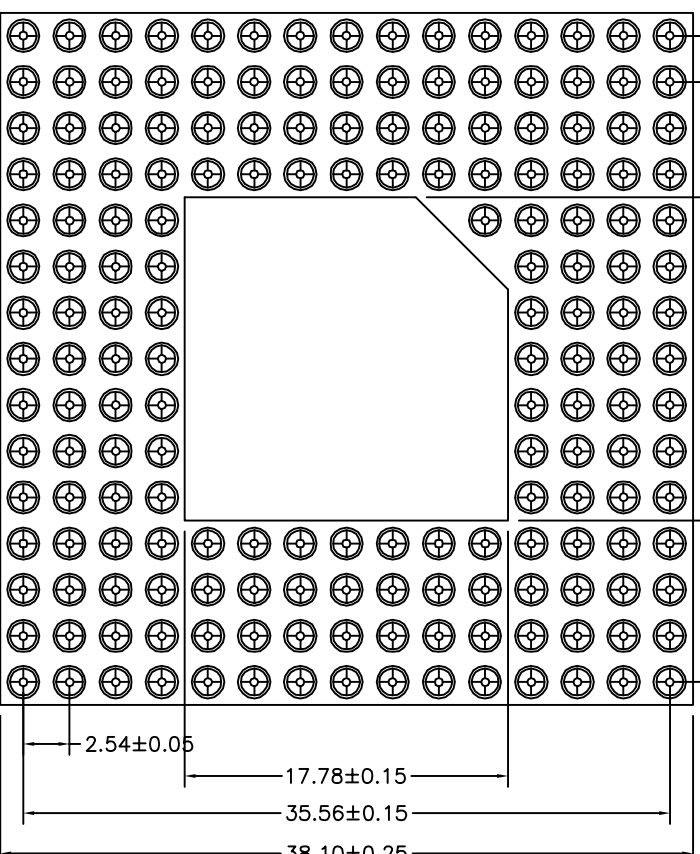
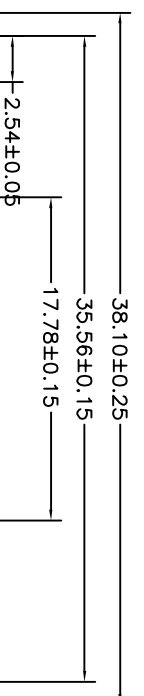

QZTA	X	X	XXX	XX	XX	XXXX	X
Pitch (mm)	A=2.54X2.54 B=2.54X1.27 C=1.27X1.27						
Angel Options	P=PA C1=PLCC-SMT C2=PLCC-DIP						
No. of Positions	XXX positions 177=177PIN						
Pin plated	T1=Tin 150u" T2=Tin 200u" G1=6/F G2=gold 3u" G3=gold 10u" G4=gold 15u" G5=gold 30u"						
CLIP plated	T1=Tin 150u" T2=Tin 200u" G1=6/F G2=gold 3u" G3=gold 10u" G4=gold 15u" G5=gold 30u"						
Pin Length Options	07/40=7.40mm						
Specifications	A=Public seat B=Female seat						

REVISION DATA		
REV	DESCRIPTION	DATE
A0	NEW DRAWING	16-5-15

Technical Data

Material:

Pin(outer sleeve):Brass, machined CuZn38Pb2

Plating(outer sleeve):

Tin Plated:2μm/80μm"Ni, 5μm/200μ"Sn

Gold Plated:2μm"/80μm"Ni, 0.8μ" gold

Plating(Contact):2μm/80μ"Ni, gold or Tin plated

Insulator:PPS UL94V-0

CLIP(Contact 4 Flinger):Beryllium copper,heat treated

Electrical:

Current rating:3Amps/contact max.

Contact resistance: ≤4mΩ/contact

Insulation resistance: ≥1000MΩ at V=100V

Operating voltage:60VAC/DC

Mechanical:

Average Insertion force with steel pin of ∅0.432: <250g

Average withdrawal force with steel pin of ∅0.432: >70g

Mechanical life cycle:min 200

Operating temperature:-40 ° C to+105 ° C

Soldering temperature:+255 ° C

dzconn 东莞市启之泰电子科技有限公司

启之泰

TOLERAVCE

X,XXX ±0.05

X,XX ±0.15

X,X ±0.20

X, ±0.30

ANGLE ±5.0°

PROJECTON		TITLE:	Pin grid array sockets
DATE:	2016-5-15	PART NO:	QZTA-P177XXX0740B
DRAWN:	TANG-S-G	DRAWING NO:	2016051520
CHECKED:		REV:	A0
APPROVED:		UNIT:	mm
		SCALE:	1:1
		SIZE:	A4
		PAGE:	1/2