

REVISION DATA		
REV	DESCRIPTION	DATE
A0	NEW DRAWING	16-4-15

Technical Data
Material: Pin(outer sleeve): Brass, machined CuZn38Pb2
Plating(outer sleeve):
Tin Plated: 2 μ m/80 μ m²Ni, 5 μ m/200 μ Sn
Gold Plated: 2 μ m²/80 μ m²Ni, 0.8 μ gold
Plating(Contact): 2 μ m/80 μ NI, gold or Tin plated
Insulator: PPS UL94V-0

Clip(Contact 6 Flinger): Beryllium copper, heat treated

Electrical:
Current rating: 3Amps/contact max.
Contact resistance: $\leq 4m\Omega$ /contact
Insulation resistance: $\geq 1000M\Omega$ at V=100V
Operating voltage: 60VAC/DC

Mechanical:
Average Insertion force with steel pin of $\square 0.43$: $< 75g$
Average withdrawal force with steel pin of $\square 0.66$: $> 25g$
Mechanical life cycle: min 200
Operating temperature: $-40^{\circ}C$ to $+105^{\circ}C$
Soldering temperature: $+255^{\circ}C$

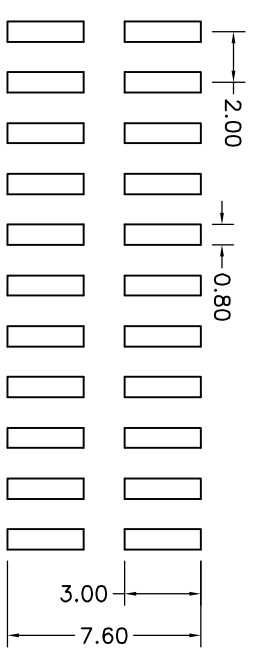
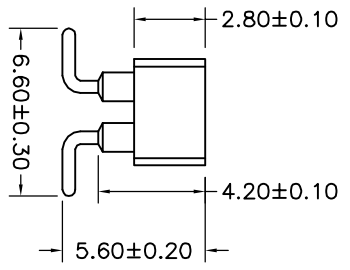
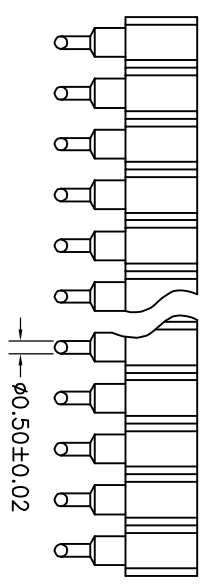
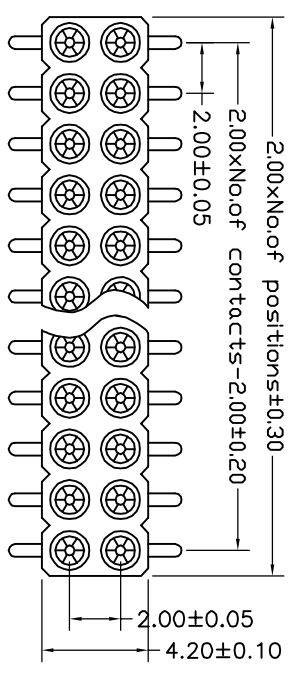

P. C. B LAYOUT

QZT	X	X	XX	XX	XX	XXXX
Pitch (mm) A=1.27 B=1.778 C=2.00 D=2.54	Angel Options D=180° R=90° S=SMT I=IC	No. of Positions XX positions	Pin plated T1=Tin 150u" G1=G/F G2=Gold 3u" G3=Gold 10u" G4=Gold 15u" G5=Gold 30u"	CLIP plated T1=Tin 150u" T2=Tin 200u" G1=G/F G2=Gold 3u" G3=Gold 10u" G4=Gold 15u" G5=Gold 30u"	Pin Length Options 0740=7.40mm	

Qztcconn 东莞市启之泰电子科技有限公司

TOLERANCE		PROJECTION		TITLE:	
X, XXX	±0.05		Double socket connector SMT	REV:	A0
X, XX	±0.15		2.00mm L=7.40mm	UNIT:	mm
X, X	±0.20			SCALE:	full
X, X	±0.30			SIZE:	A4
ANGLE	±5.0°				