

REVISION DATA		
REV	DESCRIPTION	DATE
A0	NEW DRAWING	16-4-26

Technical Data

Material:

Pin(outer sleeve): Brass, machined CuZn38Pb2
Plating(outer sleeve):

Tin Plated: $2\mu\text{m}/80\mu\text{m}^{\text{Ni}}, 5\mu\text{m}/200\mu^{\text{Sn}}$

Gold Plated: $2\mu\text{m}^{\text{Ni}}/80\mu\text{m}^{\text{Ni}}, 0.8\mu^{\text{gold}}$

Plating(Contact): $2\mu\text{m}/80\mu^{\text{Ni}}$, gold or Tin plated

Insulator: PPS UL94V-0

Clip(Contact 6 Finger): Beryllium copper, heat treated

Electrical:

Current rating: 3Amps/contact max.

Contact resistance: $\leq 4\text{m}\Omega$ /contact

Insulation resistance: $\geq 1000\text{M}\Omega$ at $V=100\text{V}$

Operating voltage: 60VAC/DC

Mechanical:

Average Insertion force with steel pin of $\square 0.43; < 75\text{g}$

Average withdrawal force with steel pin of $\square 0.66; > 25\text{g}$

Mechanical life cycle: min 200

Operating temperature: -40°C to $+105^{\circ}\text{C}$

Soldering temperature: $+255^{\circ}\text{C}$

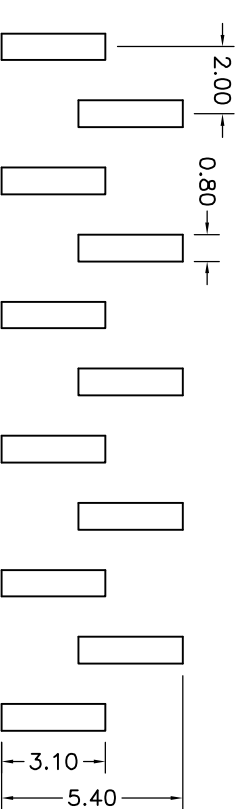
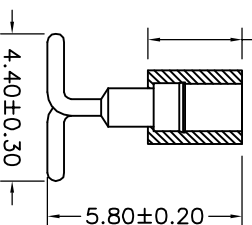
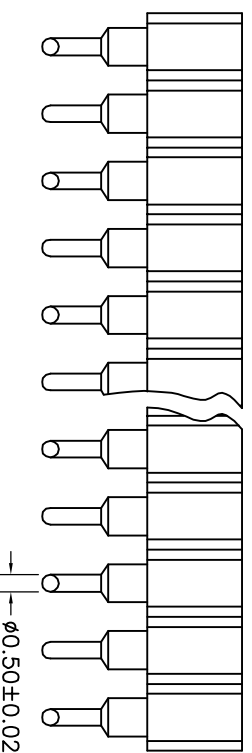
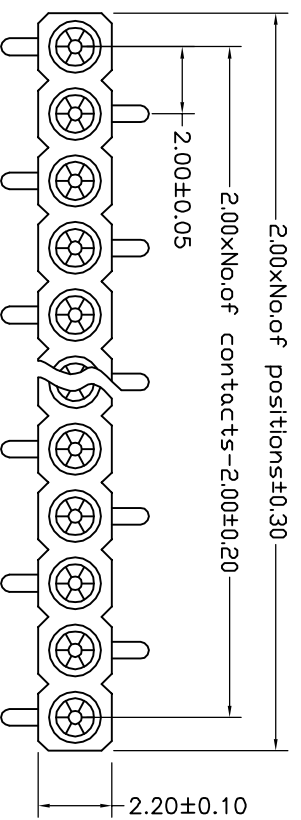

P. C. B LAYOUT

QZT	X	X	-	X	XX	XX	XX	XXXX	X
Pitch(mm) 1=1.27 B=1.778 C=2.00 D=2.54	Insulator Type code 1=Single row 2=Double row 3=Three row		Angel Options D=90° R=90° S=SMT I=IC	No. of Positions XX	Pin plated T1=Tin 150μ" T2=Tin 200μ" G1=6/F G2=Gold 30μ" G3=Gold 10μ" G4=Gold 15μ" G5=Gold 30μ"	CLIP plated T1=Tin 150μ" T2=Tin 200μ" G1=4/F G2=Gold 30μ" G3=Gold 10μ" G4=Gold 15μ" G5=Gold 30μ"	Pin Length Options 07/0=7.40mm	Specifications A=Public seat B=Female seat	

QZTconn 东莞市启之泰电子科技有限公司

TOLERANCE	PROJECTION	TITLE:
X,XXX X,XX X,X		Single row socket connector 2.00mm l=7.40 SMT
±0.05 ±0.15 ±0.20 ±0.30 ±5.0°	DATE: 2016-4-26 DRAWN: TANG-S-G	PART NO: QZTIC1-SXXXXXX0740B DRAWING NO: 2016042604
ANGLE	CHECKED:	REV: A0 UNIT: mm SCALE: FULL SIZE: A4
	APPROVED:	